

# PACKAGING DAYS 2025

FOCUS IN CUTTING.

FROM **OCTOBER 7–8, 2025**

AT WEINIG IN ILLERTISSEN.



## HIGHLIGHT: EXCLUSIVE PRODUCTION INSIGHT WITH OUR CUSTOMER

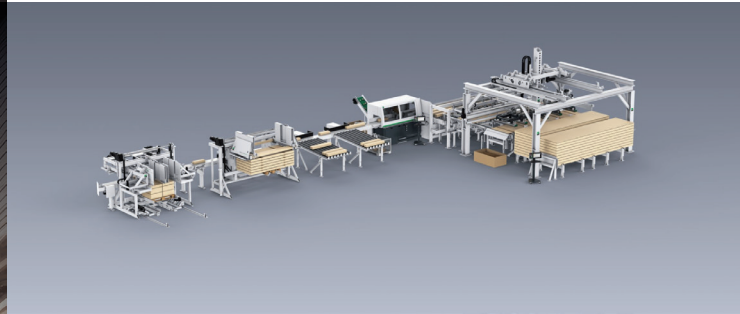

A special highlight of this year's Packaging Days is the tour and production insight at one of our customers in the packaging industry.

**The tour is possible twice a day by bus transfer:  
from 10:30 am – 12 am and from 3:30 pm – 5 pm**

Take the chance to gain new impressions and experience a fully automatic cutting line live in production.

Participation requires reservation – only limited spots available.

Once you have received your ticket, we will send you the registration link for the tour.

## GUEST LECTURES



**Gerd Ebner**  
Editor-in-chief Holzkurier

Current sales situation in the packaging industry

Availability of raw materials for packaging wood



**Marcus Kirschner**  
Managing Director of HPE

Industry overview (facts and figures)  
EU Packaging Regulation (PPWR)

## YOUR INVITATION TO THE PACKAGING DAYS

At WEINIG in Illertissen, we'll demonstrate live how to optimize your wood packaging and pallet production efficiently and sustainably – even in the face of skilled labor shortages and rising raw material costs.

Look forward to over 20 running machines, digital solutions, hands-on demonstrations, top guest exhibitors, and exclusive industry insights – all in one place.

Expert talks by industry leaders – including HPE Managing Director Marcus Kirschner – and live demonstrations will provide exciting insights into digital processes and modern cutting techniques.

An evening get-together featuring Swabian-Bavarian specialties will round off the event – the perfect opportunity to network with peers and manufacturers.

Get informed. Join us. Stay ahead.  
We look forward to welcoming you!

Your WEINIG Team

## PROGRAM OCTOBER 7 – 8, 2025

- 8:30 am** Official Start
- 9:30 am – 10 am** Guest lecture
- 10:30 am – 12 am** Production insights at our customer's site
- 2:30 pm – 3 pm** Guest lecture
- 3:30 pm – 5 pm** Production insights at our customer's site
- from 5:30 pm** Get-together with Swabian-Bavarian specialties, good beer and informative discussions with industry colleagues and manufacturers (just at Oct., 7)

**Our machines operate continuously throughout the day and are demonstrated live.**  
(except during the guest lectures)

**Food and drinks available all day.**



# DEMONSTRATION MACHINES

## PACKAGING DAYS 2025

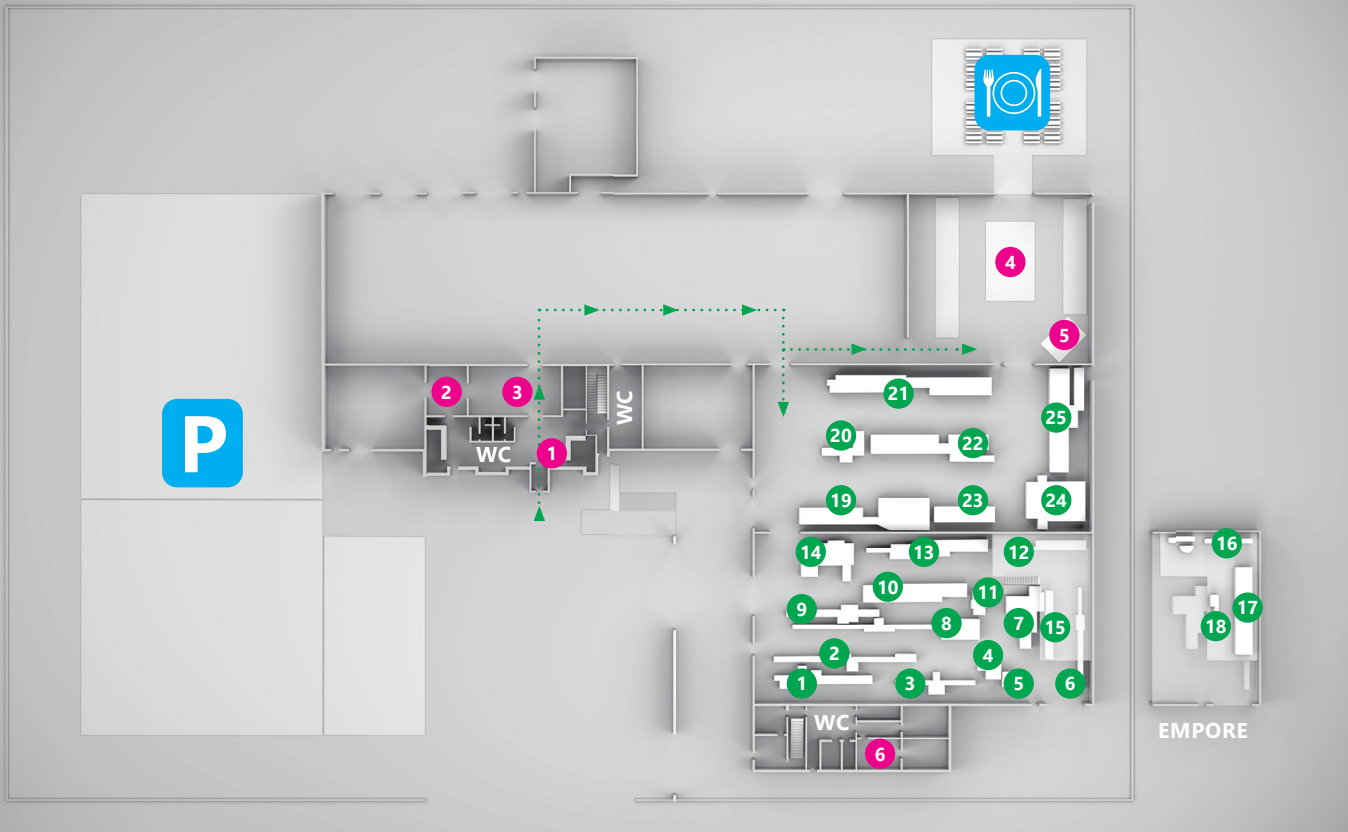

- 1 Reception/Registration
- 2 Meeting room 1
- 3 Cloakroom
- 4 Guest exhibitors
- 5 Stage
- 6 Meeting room 2
- 1 SOLID CUT TF 1500
- 2 SOLID CUT TF 2600
- 3 SOLID SCAN C 2100

- 4 SOLID PROFILE P 700
- 5 SOLID RIP V 310 M
- 6 SOLID CUT PF 900 HS
- 7 SOLID RIP P 340 M
- 8 SOLID CUT TF 8000
- 9 SOLID CUT PF 900 MD
- 10 SOLID PRESS L 2500
- 11 SOLID SPLIT B 900
- 12 SOLID RIP FX 210

- 13 SOLID PRESS B 3100
- 14 SOLID PRESS T 2500
- 15 SOLID CUT PF 500
- 16 SOLID CUT U 500 with SOLID EASYSTOP
- 17 SOLID CUT PF 550
- 18 SOLID EASYSTOP
- 19 SOLID CUT PF 550 with EUROSTACKER

- 20 SOLID RIP V 310
- 21 SOLID CUT PF 900
- 22 SOLID CUT PF 900 R
- 23 SOLID CUT PF 550 D
- 24 ZENTREX 6215 power
- 25 Techno Saw

→ To the event rooms

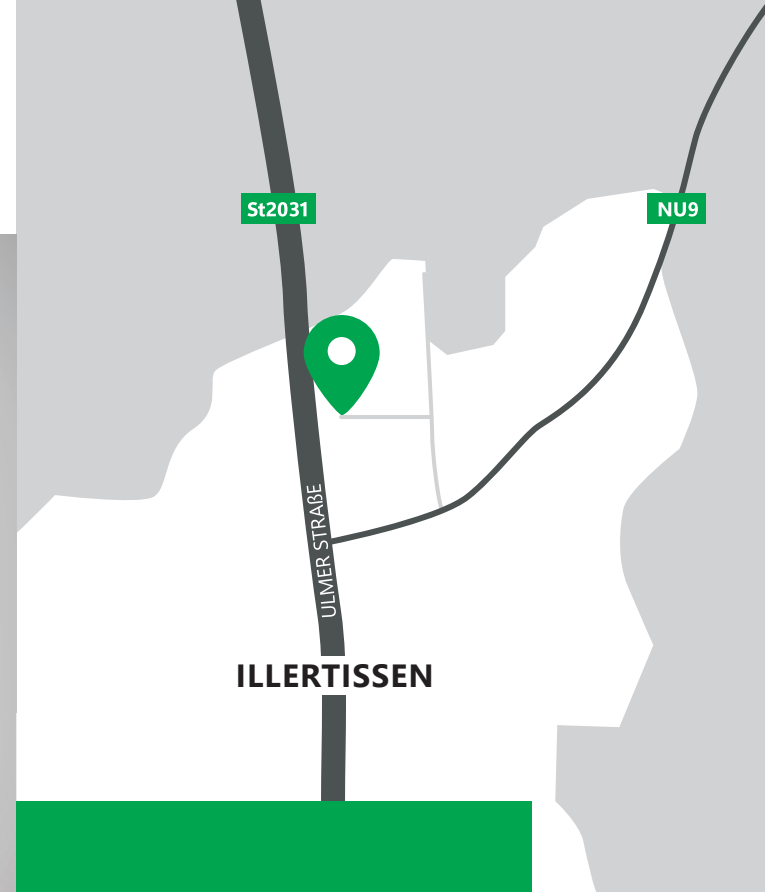

## DIRECTIONS

### WEINIG ILLERTISSEN

**WEINIG Operations GmbH & Co. KG**  
 Robert-Bosch-Strasse 4  
 89257 Illertissen, Germany  
 ExpoCenter | Werk 2

Further information and registration at:  
[packagingdays.weinig.com](http://packagingdays.weinig.com)

**REGISTER NOW**

